

Technische Lieferbedingungen

Wir sind ein vom SVTI (Schweizerischer Verein für technische Inspektionen) und vom TÜV (Technischer Überwachungsverein, BRD), gemäss AD-2000-Merkblatt W0/TRD 100, zugelassenes Herstellerwerk für Rohrbogen. Wir verfügen über das SQS-Zertifikat nach EN ISO 9001, TÜV Cert. PED.

Aufgrund unserer Zulassungen können wir folgende Dienstleistungen durchführen:

Zerstörungsfreie Prüfungen

- Durchstrahlungsprüfung (Röntgen)
- Ultraschallwanddickenmessung
- Farbeindringprüfung
- Magnetpulverprüfung
- Spektralanalyse
- Verwechslungsprüfung
- Endoskopieren
- Rauhtiefenmessung
- Ferritmessung
- Druckprobe
- Dichtheitsprüfung

Mechanisch-technologische Prüfungen

- Zugversuch
- Biege-, Aufweit-, Bördel-, Faltversuch

Härteprüfung

- nach Brinell und Vickers

Dokumentation/Atteste

Für die geprüften Werkstücke und Werkstoffe können Bescheinigungen gemäss EN 10204 ausgestellt werden. Abnahmepflichtige Teile können im Rahmen unserer Zulassung mit APZ 3.1 in Verbindung mit AD-Merkblättern W2/W4 und VD TÜV 1252-Merkblättern geliefert werden.

Wir erfüllen die Qualitätssicherungsvorschriften nationaler und internationaler Behörden wie Lloyd's, Norske Veritas, Stoomwezen, Germ. Lloyd usw. Wir arbeiten nach in- und ausländischen oder nach werkseigenen Normen und Vorschriften.

Kennzeichnung

Soweit nicht anders vereinbart, werden unsere Erzeugnisse markiert mit

Herstellerzeichen		1.4404 w
Werkstoffnummer		114,3 x 2,6
Abmessung		EN 10253-4-A
IW-Nr./Charge		CH12545/13756

Die Kennzeichnung ist mit Ink-Jet und Laser aufgetragen.

Schweissfaktor

Alle aus geschweissten Rohren hergestellten Rohrbogen und Fittings können mit Schweissfaktor $v = 1,0$ geliefert werden.

Verpackung

Alle Rohrbogen bis $\varnothing 114,3$ mm sind in umweltfreundliche Schrumpffolie verpackt und zwar:

- ≤ 38 mm in 10er-Einheiten
- ≤ 104 mm in 5er-Einheiten
- $\leq 114,3$ mm in 4er-Einheiten
- $\leq 168,3$ mm in 2er-Einheiten
- $> 168,3$ mm nicht verpackt

Zeichenerklärung

- Aus Vorrat lieferbar
- Lieferbar auf Anfrage

Technical Delivery Terms

We are a manufacturer of pipe bends authorized in accordance with the AD-2000 leaflets W0/TRD 100 by the SVTI (Schweizerischer Verein für technische Inspektionen = Swiss Association for Technical Inspections) and TÜV (Technischer Überwachungsverein = Technical Monitoring Association, Germany). We have also been awarded SQS certification in accordance with EN ISO 9001, TÜV Cert. PED.

On the base of our authorisations, we are able to carry out the following services:

Non-destructive testing

- X-ray investigation
- ultrasonic wall thickness measurement
- color penetration testing
- magnaflux testing
- spectral analysis
- unambiguous identity testing
- endoscopy
- peak-to-valley height measurement
- ferrite measurement
- pressure testing
- leak testing

Mechanical-technological testing

- tensile tests
- bending, bulding, bead, folding tests

Hardness testing

- according Brinell and Vickers

Documentation/Certificates

Certificates in accordance with EN 10204 can be issued for the workpieces and materials tested. Components subject to official approval can be supplied with Cert. 3.1 in conjunction with AD leaflet W2 and VD TÜV 1252 leaflets.

We satisfy the quality assurance regulations of national and international authorities such as Lloyd's, Norske Veritas, Stoomwezen, Germ. Lloyd, etc. We work in accordance with domestic and foreign or internal company standards and regulations.

Destination

Unless otherwise agreed, our products are marked with

manufacturer's mark
material grade
dimensions
IW-No./heat-No.



1.4404 w
114.3 x 2,6
EN 10253-4-A
CH12545/13756

The designation is applied using an inkjet printer or by laser.

Joint factor

All bends and fittings produced from welded pipes can be supplied with a joint factor $v = 1.0$.

Packaging

All elbows up to 114.3 mm diameter are packed in environmentally-friendly shrink film, i.e.:

- ≅ 38 mm in units of 10
- ≅ 104 mm in units of 5
- ≅ 114.3 mm in units of 4
- ≅ 168.3 mm in units of 2
- > 168.3 mm not packed

Explanation of symbols

- available from stock
- apply for availability



Rost- und säurebeständige Stähle

Stainless steels

Werkstoff-Nr. / Grade	AISI	SIS	C ≤	Si ≤	Mn ≤	P ≤	S ≤	Cr	Mo	Ni	Ti	N ≤	Cu
1.4301 X5 Cr Ni 18 10	-	-	0,07	1,0	2,0	0,045	0,015	17,0-19,5	-	8,0-10,5	-	0,11	-
-	304	-	0,08	0,75	2,0	0,040	0,030	18,0-20,0	-	8,0-11,0	-	-	-
-	-	2333	0,07	1,0	2,0	0,045	0,030	17,0-19,0	-	8,5-11,0	-	-	-
1.4306 X2 Cr Ni 19 11	-	-	0,03	1,0	2,0	0,045	0,015	18,0-20,0	-	10,0-12,0	-	0,11	-
-	304 L	-	0,035	0,75	2,0	0,040	0,030	18,0-20,0	-	8,0-13,0	-	-	-
-	-	2352	0,03	1,0	2,0	0,045	0,030	17,0-19,0	-	9,0-12,0	-	-	-
1.4307 X2 Cr Ni 18-9	-	-	0,03	1,0	2,0	0,045	0,015	17,5-19,5	-	8,0-10,0	-	0,11	-
1.4541 X6 Cr Ni Ti 18 10	-	-	0,08	1,0	2,0	0,045	0,015	17,0-19,0	-	9,0-12,0	5 x % C ≤ 0,7	-	-
-	321	-	0,08	0,75	2,0	0,040	0,030	17,0-20,0	-	9,0-13,0	≥ 5 x % C ≤ 0,7	-	-
-	-	2337	0,08	1,0	2,0	0,045	0,030	17,0-19,0	-	9,0-12,0	≥ 5 x % C ≤ 0,8	-	-
1.4401 X5 Cr Ni Mo 17 12 2	-	-	0,07	1,0	2,0	0,045	0,015	16,5-18,5	2,0-2,5	10,5-13,0	-	0,11	-
-	316	-	0,08	0,75	2,0	0,040	0,030	16,0-18,0	2,0-3,0	11,0-14,0	-	-	-
-	-	2347	0,05	1,0	2,0	0,045	0,030	16,0-18,5	2,0-2,5	10,5-14,0	-	-	-
1.4404 X2 Cr Ni Mo 17 12 2	-	-	0,03	1,0	2,0	0,045	0,015	16,5-18,5	2,0-2,5	10,0-13,0	-	0,11	-
-	316 L	-	0,035	0,75	2,0	0,040	0,030	16,0-18,0	2,0-3,0	10,0-15,0	-	-	-
-	-	2348	0,03	1,0	2,0	0,045	0,030	16,5-18,5	2,0-2,5	11,0-14,0	-	-	-
1.4432 X2 Cr Ni Mo 17 12 3	-	-	0,03	1,0	2,0	0,045	0,015	16,5-18,5	2,5-3,0	10,5-13,0	-	0,11	-
1.4435 X2 Cr Ni Mo 18 14 3	-	-	0,03	1,0	2,0	0,045	0,015	17,0-19,0	2,5-3,0	12,5-15,0	-	0,11	-
-	316 L	-	0,035	0,75	2,0	0,040	0,030	16,0-18,0	2,0-3,0	10,0-15,0	-	-	-
-	-	2353	0,03	1,0	2,0	0,045	0,030	16,5-18,5	2,5-3,0	11,5-14,5	-	-	-
1.4436 X5 Cr Ni Mo 17 13 3	-	-	0,05	1,0	2,0	0,045	0,015	16,5-18,5	2,5-3,0	10,5-13,0	-	0,11	-
-	316	-	0,08	0,75	2,0	0,040	0,030	16,0-18,0	2,0-3,0	11,0-14,0	-	-	-
-	-	2343	0,05	1,0	2,0	0,045	0,030	16,0-18,5	2,5-3,0	10,5-14,0	-	-	-
1.4571 X6 Cr Ni Mo Ti 17 12 2	-	-	0,08	1,0	2,0	0,045	0,015	16,5-18,5	2,0-2,5	10,5-13,5	5 x C ≤ 0,7	-	-
-	316 Ti	-	0,08	0,75	2,0	0,040	0,030	16,0-18,0	2,0-3,0	11,0-14,0	5 x (C+N) max. 0,7, N max. 0,1	-	-
-	-	2350	0,08	1,0	2,0	0,045	0,030	16,5-18,5	2,0-2,5	10,5-14,0	≤ 5 x % C ≤ 0,8	-	-

Hochsäurebeständige Stähle / High-alloy austenitic stainless steels

Auf Anfrage / on request

Duplex, ferritisch-austenitisch / Duplex, ferritic-austenitic

Auf Anfrage / on request

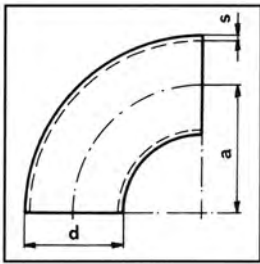

Geschweisste Rohrbogen in Edelstahl Welded elbows in stainless steel

Bauart 3 90°
EN 10253-4

★ AD 2000 W2

DN	Ø aussen / outside			Gewicht / Stück weight / piece kg ≈	304 L	1.4541		316 L	1.4571	
	d	s	a		1.4307	★	★	1.4404 1.4432	★	★
	mm	mm	mm							
10	12,0	1,5	26	0,015	●			●		
	13,5	1,6	20,0	0,020	●			●		
	15,0	1,5	27,5	0,022		●			●	
	17,2	1,6	27,5	0,028	●	●		●	●	●
15	18,0	1,5	22,5	0,022	●	●		●	●	
	20,0	1,5	25	0,030	●	●		●	●	
	20,0	2,0	25	0,034	●	●		●	●	
	21,3	1,6	28	0,034	●	●	●	●	●	●
	21,3	2,0	28	0,040	●	●		●	●	
	21,3	2,6	28	0,056	●	●		●	●	
20	23,0	1,5	25	0,030	●			●	●	
	25,0	1,5	27,5	0,038	●	●		●	●	
	25,0	2,0	27,5	0,046	●	●		●	●	
	26,9	1,6	29	0,042	●	●	●	●	●	●
	26,9	2,0	29	0,056	●	●		●	●	
	26,9	2,6	29	0,068	●	●		●	●	
25	28,0	1,5	32,5	0,050	●	●		●	●	
	28,0	2,0	32,5	0,067		●			●	
	30,0	1,5	33,5	0,054	●					
	30,0	2,0	33,5	0,070	●	●		●	●	
	32,0	2,0	35	0,082	●					
	33,0	1,5	49,5	0,090	●			●		
	33,7	1,6	38	0,070	●	●		●	●	
	33,7	2,0	38	0,088	●	●	●	●	●	●
	33,7	2,6	38	0,115		●			●	
33,7	3,2	38	0,142	●	●		●	●		
32	35,0	1,5	45	0,082	●	●		●	●	
	35,0	2,0	45	0,114	●	●		●	●	
	38,0	1,5	45	0,088	●	●		●	●	
	38,0	1,5	57,2	0,121	●			●		
	38,0	2,0	45	0,120	●	●		●	●	
	40,0	1,5	45	0,098	●					
	40,0	2,0	45	0,132	●	●		●	●	
	42,4	1,6	48	0,112	●	●		●	●	
	42,4	2,0	48	0,123	●	●	●	●	●	●
	42,4	2,6	48	0,190		●			●	
	42,4	3,2	48	0,234	●	●		●	●	

Lieferprogramm: ● = aus Vorrat lieferbar ○ = Sonderanfertigung, Preis und Termin auf Anfrage
Delivery: ● = Available from stock ○ = Special design, price and delivery time on request

Geschweisste Rohrbogen in Edelstahl Welded elbows in stainless steel

Bauart 3 90°

★ AD 2000 W2

DN	Ø aussen / outside			Gewicht / Stück weight / piece kg ≈	304 L	1.4541		316 L	1.4571	
	d mm	s mm	a mm		1.4307		★	1.4404 1.4432		★
40	43,0	x 1,5	47,5	0,108	●	●			●	
	43,0	x 1,5	64,5	0,160	●			●		
	44,5	x 2,0	51	0,160	●	●		●	●	
	44,5	x 2,6	51	0,208		●			●	
	48,3	x 1,6	57	0,152	●	●		●	●	
	48,3	x 2,0	57	0,200	●	●	●	●	●	●
	48,3	x 2,6	57	0,258		●			●	
	48,3	x 3,2	57	0,318	●	●		●	●	
50	50,0	x 2,0	71	0,274	●				●	
	50,8	x 1,5	76,2	0,225	●			●		
	51,0	x 1,5	67,5	0,192	●			●		
	51,0	x 2,0	67,5	0,252	●	●		●	●	
	52,0	x 1,5	70,0	0,200	●					
	53,0	x 1,5	72,5	0,224	●	●		●	●	
	54,0	x 2,0	70	0,278	●	●		●	●	
	57,0	x 2,0	75	0,310	●	●		●	●	
	57,0	x 3,0	75	0,480		●		●	●	
	60,3	x 1,6	76	0,278	●	●		●	●	
	60,3	x 2,0	76	0,328	●	●	●	●	●	●
	60,3	x 2,6	76	0,426	●	●		●	●	
	60,3	x 2,9	76	0,473		●			●	
	60,3	x 3,0	76	0,500	●			●		
	60,3	x 3,6	76	0,586	●	●		●	●	
	63,5	x 1,6	82,5	0,358	●			●		
	63,5	x 2,0	82,5	0,388				●		
	69,0	x 2,0	92	0,450	●			●		
65	70,0	x 2,0	92	0,472	●	●		●	●	
	73,0	x 1,5	95	0,420	●			●		
	76,0	x 1,5	114,3	0,500	●			●		
	76,1	x 1,6	95	0,432	●			●		
	76,1	x 2,0	95	0,522	●	●		●	●	
	76,1	x 2,3	95	0,598	●	●	●	●	●	●
	76,1	x 2,6	95	0,674	●	●		●	●	
	76,1	x 2,9	95	0,725		●			●	
	76,1	x 3,0	95	0,760	●			●		
	76,1	x 3,6	95	0,902	●	●		●	●	
80	84,0	x 2,0	105	0,646		●			●	
	84,0	x 2,0	120	0,748	●			●		
	88,9	x 2,0	114	0,776	●	●		●	●	
	88,9	x 2,3	114	0,880	●	●	●	●	●	●
	88,9	x 2,6	114	0,982	●	●		●	●	
	88,9	x 2,9	114	1,090		●			●	
	88,9	x 3,0	114	1,130	●			●		
	88,9	x 3,2	114	1,205		●			●	

Geschweisste Rohrbogen in Edelstahl Welded elbows in stainless steel

Bauart 3 90°

★ AD 2000 W2

DN	Ø aussen / outside			Gewicht / Stück weight / piece kg ≈	304 L	1.4541		316 L	1.4571	
	d mm	s mm	a mm		1.4307	★	★	1.4404 1.4432	★	★
100	101,6	2,0	133,5	1,005	●			●		
	104,0	2,0	150	1,146	●	●		●	●	
	108,0	2,0	142,5	1,207		●			●	
	108,0	3,0	142,5	1,810		●			●	
	108,0	4,0	142,5	2,414		●			●	
	114,3	2,0	152	1,292	●	●		●	●	
	114,3	2,6	152	1,806	●	●	●	●	●	●
	114,3	2,9	152	1,852		●			●	
	114,3	3,0	152	1,916	●			●		
	114,3	3,6	152	2,300		●			●	
125	129,0	2,0	187,5	1,830	●	●		●	●	
	133,0	3,0	181	2,750		●			●	
	139,7	2,0	190	1,970	●	●		●	●	
	139,7	2,6	190	2,534	●	●	●	●	●	●
	139,7	2,9/3,0	190	3,010	●	●		●	●	
	139,7	4,0	190	4,010		●			●	
150	154,0	2,0	225	2,712	●	●		●	●	
	156,0	3,0	225	3,916	●			●		
	159,0	3,0	216	3,900		●			●	
	159,0	4,0	216	5,150		●			●	
	168,3	2,0	229	2,926	●	●		●	●	
	168,3	2,5/2,6	229	4,038	●	●		●	●	
	168,3	2,9/3,0	229	4,328	●	●		●	●	
	168,3	4,0	229	5,900	●	●		●	●	
200	204,0	2,0	300	4,730	●			●	●	
	205,0	2,5	300	6,764					●	
	206,0	3,0	300	6,860				●		
	219,1	2,0	305	4,872	●	●		●	●	
	219,1	2,5/2,6	305	6,290	●	●		●	●	
	219,1	3,0	305	7,442	●	●		●	●	
250	254,0	2,0	375	8,416	●			●	●	
	255,0	2,5	375	9,080				●		
	256,0	3,0	375	11,916	●			●		
	273,0	2,0	381	8,010	●					
	273,0	3,0	381	12,020	●	●		●	●	
300	304,0	2,0	450	10,520	●			●		
	306,0	3,0	450	16,840	●			●		
	323,9	3,0	457	17,140	●	●		●	●	
350	356,0	3,0	533	22,400	●			●		
400	406,0	3,0	610	28,580	●	●		●	●	

Lieferprogramm: ● = aus Vorrat lieferbar ○ = Sonderanfertigung, Preis und Termin auf Anfrage
Delivery: ● = Available from stock ○ = Special design, price and delivery time on request

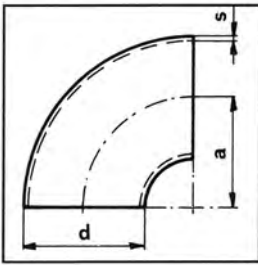

Nahtlose Rohrbogen in Edelstahl Seamless elbows in stainless steel

Bauart 3 90°
EN 10253-4

Mit AD 2000 W2 / W10

DN	Ø aussen / outside			Gewicht / Stück weight / piece		1.4541	1.4571	1.4404
	d	s	a			AISI 321	AISI 316Ti	AISI 316L
	mm	mm	mm	kg ≈				
10	12,0	x 1,5	26	0,015	●	●	●	
	13,5	x 1,6	20	0,018		●		
	13,5	x 2,3	20	0,020			●	
	15,0	x 1,5	27,5	0,020		●	●	
	15,0	x 2,0	27,5	0,026	●	●		
	16,0	x 2,0	27,5	0,029	●	●		
	17,2	x 1,6	27,5	0,028			●	
	17,2	x 2,0	27,5	0,032		●		
	17,2	x 2,3	27,5	0,036	○	●	●	
15	18,0	x 1,5	22,5	0,022			●	
	18,0	x 2,0	22,5	0,028	●	●		
	20,0	x 1,5	25	0,030			●	
	20,0	x 2,0	25	0,040	●			
	21,3	x 1,6	28	0,034			●	
	21,3	x 2,0	28	0,040	●	●		
	21,3	x 2,6	28	0,056	●	●	●	
	21,3	x 3,2	28	0,056	○	●		
20	23,0	x 1,5	25	0,030			●	
	25,0	x 1,5	27,5	0,038			●	
	25,0	x 2,0	27,5	0,046	○	●	●	
	26,9	x 1,6	29	0,042			●	
	26,9	x 2,0	29	0,056	●	●		
	26,9	x 2,3	29	0,062	●	●		
	26,9	x 2,6	29	0,068	●	●	●	
	26,9	x 3,2	29	0,090	○	●		
	26,9	x 4,0	29	0,120	○	●		
25	28,0	x 1,5	32,5	0,050	●	●	●	
	28,0	x 2,0	33,5	0,066	●	●		
	30,0	x 2,0	33,5	0,070	○	●	●	
	30,0	x 3,0	33,5	0,105	○	●		
	33,7	x 2,0	38	0,088	●	●	●	
	33,7	x 2,6	38	0,115	●	●		
	33,7	x 3,2	38	0,142	●	●	●	
	33,7	x 4,0	38	0,176	●	●		
	33,7	x 4,0	38	0,176	●	●		
	33,7	x 4,5	38	0,198	●			
32	35,0	x 2,0	45	0,114			●	
	38,0	x 2,6	45	0,158			●	
	40,0	x 2,0	45	0,132	●			
	42,4	x 2,0	48	0,123	●	●	●	
	42,4	x 2,6	48	0,190	●	●		
	42,4	x 3,2	48	0,234	○	●	●	
	42,4	x 3,6	48	0,262	○	●		
	42,4	x 4,0	57	0,200	○	●		

Nahtlose Rohrbogen in Edelstahl Seamless elbows in stainless steel

Bauart 3 90°

DN	Ø aussen / outside			Gewicht / Stück weight / piece	1.4541 AISI 321	1.4571 AISI 316Ti	1.4404 AISI 316L
	d mm	s mm	a mm				
40	44,5 x 2,0		51	0,160	○	●	●
	44,5 x 2,6		51	0,208	○	●	
	48,3 x 2,0		57	0,200	●	●	●
	48,3 x 2,6		57	0,258	●	●	
	48,3 x 3,2		57	0,318	○	●	●
	48,3 x 3,6		57	0,356	○	●	
	48,3 x 4,0		57	0,392	●	●	
	48,3 x 5,0		57	0,490	○	●	
50	51,0 x 2,6		67,5	0,342			●
	54,0 x 2,0		70	0,278			●
	57,0 x 2,9		75	0,468	●	●	●
	57,0 x 4,0		75	0,624	●	●	●
	60,3 x 2,0		76	0,328	●	●	
	60,3 x 2,6		76	0,426		●	●
	60,3 x 2,9		76	0,473	●	●	
	60,3 x 3,2		76	0,524	○	●	●
	60,3 x 3,6		76	0,586	●	●	●
	60,3 x 4,0		76	0,684	○	●	●
	60,3 x 5,0		76	0,810	○	●	
	64,0 x 2,0		83	0,430	○	●	●
65	76,1 x 2,0		95	0,522		●	
	76,1 x 2,6		95	0,674	●	●	●
	76,1 x 2,9		95	0,725	●	●	
	76,1 x 3,2		95	0,725	○	●	
	76,1 x 3,6		95	0,902	●	●	●
	76,1 x 4,0		95	1,000	○	●	
	76,1 x 5,0		95	1,125	●	●	
80	88,9 x 2,6		114	0,982	●	●	●
	88,9 x 2,9		114	1,090		●	
	88,9 x 3,2		114	1,205	●	●	
	88,9 x 4,0		114	1,205			●
	88,9 x 5,0		114	1,454	○	●	
100	108,0 x 4,0		142,5	2,414	○	●	●
	114,3 x 2,6		152	1,658	○	●	
	114,3 x 3,0		152	1,916	○	●	
	114,3 x 3,6		152	2,300	●	●	
	114,3 x 4,0		152	2,900	○	●	
	114,3 x 4,5		152	3,100	○	●	●
125	139,7 x 4,0		190,5	4,090	○	●	
150	159,0 x 4,5		216	5,790	○	●	

2

Lieferprogramm: ● = aus Vorrat lieferbar ○ = Sonderanfertigung, Preis und Termin auf Anfrage
Delivery: ● = Available from stock ○ = Special design, price and delivery time on request

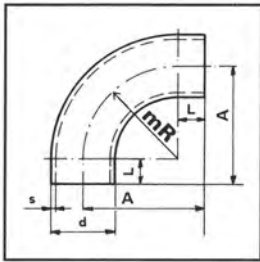

Schenkelbogen in Edelstahl Elbows with straight ends in stainless steel

Bauart 3 90°

Hergestellt aus geschweisstem Rohr DIN EN 10217-7 mit bearbeiteter Innennaht
Produced from welded tube acc. to DIN EN 10217-7 with inseam finish

DN	Ø Aussen Outside		Radius Radius	Schenkel Straight ends	Achsmasse Center to Face	Gewicht / Stück Weight / piece	1.4307	1.4571
	d mm	s mm	mR mm	L mm	A mm	kg		
6	10,2 x 1,6		20,0	25,0	45,0	0,028	○	○
10	13,5 x 1,6		20,0	25,0	45,0	0,039	●	●
12	17,2 x 1,6		28,0	25,0	53,0	0,058	●	●
15	21,3 x 1,6		30,0	25,0	55,0	0,076	●	●
20	26,9 x 1,6		28,5	40,0	68,5	0,126	●	●
25	33,7 x 2,0		38,0	40,0	78,0	0,222	●	●
32	42,4 x 2,0		47,5	40,0	87,5	0,313	●	●
40	48,3 x 2,0		57,0	40,0	97,0	0,394	●	●
50	60,3 x 2,0		76,0	40,0	116,0	0,584	●	●
65	76,1 x 2,0		95,0	55,0	150,0	0,964	●	●
80	88,9 x 2,0		114,5	55,0	169,5	1,446	●	●
100	114,3 x 2,0		152,5	55,0	207,5	2,250	●	●
125	139,7 x 2,6		190,5	55,0	245,5	3,680	○#	○#
150	168,3 x 2,6		228,5	55,0	283,5	5,110	○#	○#

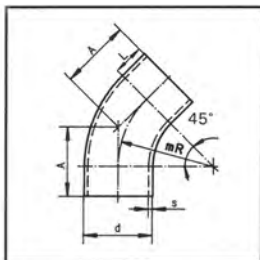

Bauart 3 45°

Hergestellt aus geschweisstem Rohr DIN EN 10217-7 mit bearbeiteter Innennaht
Produced from welded tube acc. to DIN EN 10217-7 with inseam finish

DN	Ø Aussen Outside		Radius Radius	Schenkel Straight ends	Achsmasse Center to Face	Gewicht / Stück Weight / piece	1.4307	1.4571
	d mm	s mm	mR mm	L mm	A mm	kg		
6	10,2 x 1,6		20,0	25,0	33,3	0,023	○	○
10	13,5 x 1,6		20,0	25,0	33,3	0,030	●	●
12	17,2 x 1,6		28,0	25,0	36,6	0,045	●	●
15	21,3 x 1,6		30,0	25,0	37,4	0,058	●	●
20	26,9 x 1,6		28,5	40,0	51,8	0,103	●	●
25	33,7 x 2,0		38,0	40,0	55,7	0,174	●	●
32	42,4 x 2,0		47,5	40,0	59,7	0,236	●	●
40	48,3 x 2,0		57,0	40,0	63,6	0,289	●	●
50	60,3 x 2,0		76,0	40,0	71,5	0,408	●	●
65	76,1 x 2,0		95,0	55,0	94,5	0,686	●	●
80	88,9 x 2,0		114,5	55,0	102,4	0,997	●	●
100	114,3 x 2,0		152,5	55,0	118,2	1,483	●	●
125	139,7 x 2,6		190,5	55,0	133,9	2,330	○#	○#
150	168,3 x 2,6		228,5	55,0	149,7	3,155	○#	○#

kalt gebogen über Dorn und im Anschlussmass kalibriert
cold bended and sized to roundness at the ends

Enden für Orbit Schweißung bearbeitet
Ends prepared for Orbital welding

(*) 1.4404

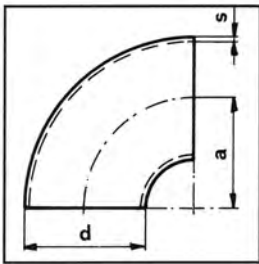

Geschweisste Rohrbogen in Edelstahl Welded elbows in stainless steel

Bauart 2 90°

DN mm	Ø aussen / outside			Gewicht / Stück weight / piece kg ≈	1.4541 AISI 321	1.4571 AISI 31651	304 L 1.4307	316 L 1.4404	nahtlos seamless 1.4541
	d	s	a						
80	85,0	2,0	90	0,61			●	●	
	88,9	2,0	76	0,62	●	●			
	88,9	3,2	76	0,99					●
100	104,0	2,0	100	0,75			●	●	
125	129,0	2,0	125	1,18			○	●	
	139,7	2,5	125	1,18				●	
150	154,0	2,0	150	1,80			●	●	
	155,0	2,5	150	2,10				●	
	168,3	3,0	152	2,50				●	
200	205,0	2,5	200	4,00				●	
	219,1	3,0	203	5,20				●	
250	255,0	2,5	250	6,00				●	
	273,0	3,0	254	8,10				●	
300	305,0	2,5	300	8,70				●	
	323,9	3,0	305	11,60				●	
350	356,0	3,0	356	14,80				●	
400	406,0	3,0	406	19,30				●	
450	457,0	3,0	457	24,50				●	
500	508,0	3,0	508	30,80				●	

2

Lieferprogramm: ● = aus Vorrat lieferbar ○ = Sonderanfertigung, Preis und Termin auf Anfrage
Delivery: ● = Available from stock ○ = Special design, price and delivery time on request

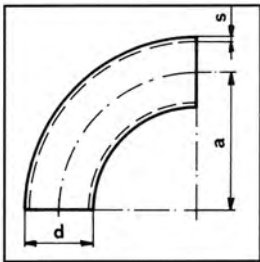

Rohrbogen in Edelstahl Elbows in stainless steel

Bauart 5 90°
EN 10253-4

DN	Ø aussen / outside			Gewicht / Stück weight / piece kg ≈	geschweisst / welded			nahtlos seamless 1.4435/ 1.4404
	d mm	s mm	a mm		316 Ti 1.4571	304 L 1.4307	316 L 1.4404 1.4432	
10	17,2	1,6	43	0,040				●
15	18,0	1,5	49	0,050				●
	20,0	1,5	50	0,055				●
	21,3	1,6	42,5	0,060		●	●	
	21,3	2,0	42,5	0,065	●	●	●	
	21,3	2,6	42,5	0,070			●	●
20	23,0	1,5	55	0,065		●	●	
	25,0	1,5	55	0,080				●
	26,9	1,6	57,5	0,090		●	●	
	26,9	2,0	57,5	0,110	●	●	●	
	26,9	2,6	57,5	0,145				●
25	28,0	1,5	65	0,100		●	●	
	30,0	2,0	69	0,125		●	●	
	33,7	2,0	72,5	0,180	●	●	●	
	33,7	3,2	72,5	0,280				●
32	35,0	2,0	75	0,190				●
	38,0	2,0	85	0,240				●
	40,0	2,0	95	0,270		●	●	
	42,4	2,0	92,5	0,280	●	●	●	●
	42,4	2,6	92,5	0,365	●			
	42,4	3,2	92,5	0,450				●
40	44,5	2,0	100	0,310		●	●	
	48,3	2,0	107,5	0,390	●	●	●	
	48,3	3,2	107,5	0,630				●
50	54,0	2,0	122	0,460		●	●	
	60,3	2,0	135	0,610	●	●	●	
	60,3	2,6	135	0,775			●	
	60,3	3,6	135	1,080				●

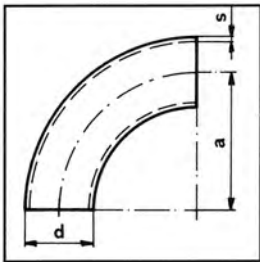

Rohrbogen in Edelstahl Elbows in stainless steel

Bauart 5 90°

DN	Ø aussen / outside			Gewicht / Stück weight / piece kg ≈	geschweisst / welded		
	d mm	s mm	a mm		316 Ti 1.4571	304 L 1.4307	316 L 1.4404 1.4432
65	70,0 x 2,0		160	0,770		●	●
	76,1 x 2,0		175	0,985	●	●	●
	76,1 x 2,3		175	1,165			●
	76,1 x 2,6		175	1,200			●
80	84,0 x 2,0		200	0,770		●	●
	88,9 x 2,0		205	1,335	●	●	●
	88,9 x 2,3		205	1,460			●
	88,9 x 2,6		205	1,750			●
100	104,0 x 2,0		250	1,900		●	●
	114,3 x 2,0		270	2,355	●	●	●
	114,3 x 2,6		270	2,900	●		●
125	129,0 x 2,0		312,5	2,790	●	●	●
	139,7 x 2,6		330	4,430	●	●	●
150	154,0 x 2,0		375	4,500	●	●	●
	168,3 x 2,6		390	6,325	●	●	●
200	204,0 x 2,0		500	7,900		●	●
	219,1 x 3,0		510	12,820		●	●
250	273,0 x 3,0		650	20.500		●	●
300	323,9 x 3,0		775	29.000		●	●

2

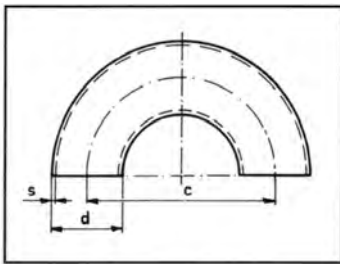

Geschweisste Rohrbogen in Edelstahl Welded elbows in stainless steel

Bauart 3 180°

EN 10253-4

DN	Ø aussen / outside			Gewicht / Stück weight / piece	304 L 1.4307	316 L 1.4404 1.4435
	d mm	s mm	c mm			
15	20,0	x 1,5	50	0,060	●	
	21,3	x 1,6	60	0,070		●
20	25,0	x 2,0	55	0,090		●
	26,9	x 2,6	57	0,135		●
25	33,7	x 2,0	76	0,175	●	●
	33,7	x 3,2	76	0,285		●
32	38,0	x 2,0	90	0,240		●
	42,4	x 2,0	95	0,245	●	●
40	44,5	x 2,0	102	0,320		●
	48,3	x 2,0	114	0,400	●	●
50	54,0	x 2,0	140	0,550	●	
	60,3	x 2,0	152	0,650		●
	60,3	x 2,6	152	0,850	●	

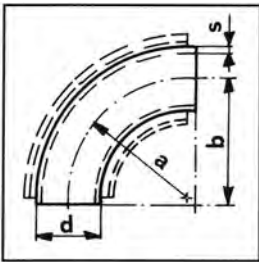

Rohrbogen für Doppelmantelrohre Bends for jacketed pipes

Type DMR 90°

* Bitte separat bestellen
* Please order separately

DN	Innenbogen Ø aussen Inner Bend Ø outside	* passende Aussenbogen * fit outer Bends	«theor. Rad.»	«Baumass»	Gewicht / Stück weight / piece	nahtlos seamless
DMR/3d	d mm s mm	3d, 90°	a mm	b mm	kg	1.4435/ 1.4404
25/40	33,7 × 2,0	48,3 × 2,0	57	65	0,17	●
25/50	33,7 × 2,0	60,3 × 2,6	76	85	0,22	●
32/50	42,4 × 2,0	60,3 × 2,6	76	85	0,28	●
40/65	48,3 × 2,0	76,1 × 2,6	95	105	0,39	●
50/80	60,3 × 2,6	88,9 × 2,6	114,5	125	0,75	●
65/100	76,1 × 2,6	114,3 × 2,6	152,5	160	1,24	●
80/100	88,9 × 2,6	114,3 × 2,6	152,5	162,5	1,48	●
100/125	114,3 × 2,6	139,7 × 2,6	190,5	201	2,33	1.4571 ●